



PRODUCT CATALOG



TM

INTRODUCTION 04

MOBILE OFFICES

Models MO208 and MO248 05

Model MO328 06

Model MO3610 07

Models MO4410 and MO4412 08

Models MO5010 and MO5012 09

Models MO6012 and MO6412 10

Models SM6024 and SM6424 11

PRODUCT INNOVATION

FLEX™ 12

Redi-Plex 13

GROUND LEVEL CONTAINER

OFFICES

Models CO208 and CO408 14

Model CS408 15

SALES OFFICES

Models SO4812 and SO6412 16

Models SO4824 and SO6424 17

STORAGE CONTAINERS

Model CT208 18

Model CT408 19

THE ESSENTIALS 20

WE ARE PASSIONATE ABOUT SOLVING SPACE PROBLEMS

It began with the creation of an office on wheels that could move along with crews as they built miles of interstate highways in the 1950s. It continues to evolve today with panelized products that can be configured in a multitude of ways to thoughtfully curated packages – our Essentials packages with a mix of furniture, appliances and add-ons that outfit your mobile office with everything you need to be “ready to work”.

What prompts the need for additional space? The most typical reasons are company growth,

new construction, renovations, changes in school population, and both natural and man-made disasters. Our goal is to provide the best customer service in the industry and we work hard to make your leasing experience easy, efficient, and economical. Now, pairing our modular solutions with one of our Essentials packages increases the value of that service significantly and ensures you are “ready to work” from day one. You can also be assured that our products are made with durable, high quality materials that meet national and state building, electrical, mechanical and plumbing codes.

Headquartered in the historic Fell’s Point area of Baltimore, Maryland, we are proud to be the modular supplier of choice for both national corporations as well as local businesses. All of our customers are served by dedicated sales and service teams operating branches that are an integral part of local communities in over 90 locations.

The passion that began over fifty years ago is rekindled every time we connect with our customers. For us, there are no space problems just solutions.

MODELS MO208 & MO248

Size(s)

20' or 24' Long (including hitch)
16' or 20' Box size
8' Wide
7' Ceiling height

Interior Finish

Paneled walls
Vinyl tile floors
Gypsum ceiling

Windows / Doors

Horizontal slider windows
Two vision panel doors with standard locks

Heating / Cooling

Electric baseboard heat
Thru-wall AC unit

Electric

Fluorescent ceiling lights
Breaker panel

Exterior Finish / Frame

Aluminum siding
I-Beam frame
Standard drip rail gutters

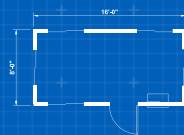

Model MO208 shown



Model MO248 shown

**Additional floor plans available. Floor plans and specifications may vary from those shown, and are subject to in-stock availability.*

MODEL M0328



Size(s)

32' Long (including hitch)
28' Box size
8' Wide
7' Ceiling height

Windows / Doors

Horizontal slider windows
Two vision panel doors with standard locks

Electric

Fluorescent ceiling lights
Breaker panel

Interior Finish

Paneled walls
Vinyl tile floors
Gypsum ceiling
Private office(s)

Heating / Cooling

Electric baseboard heat
Thru-wall AC unit

Exterior Finish / Frame

Aluminum siding
I-Beam frame
Standard drip rail gutters

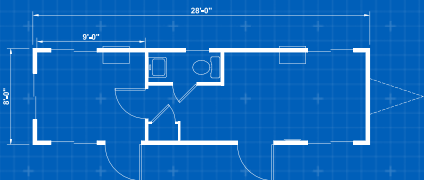

MODEL M03610

Size(s)

36' Long (including hitch)
32' Box size
10' Wide
8' Ceiling height

Interior Finish

Paneled walls
Vinyl tile floors
Gypsum ceiling
Private offices(s)

Windows / Doors

Horizontal slider windows
Two vision panel doors with standard locks

Heating / Cooling

Electric baseboard heat
Thru-wall AC unit

Electric

Fluorescent ceiling lights
Breaker panel

Exterior Finish / Frame

Aluminum siding
I-Beam frame
Standard drip rail gutters

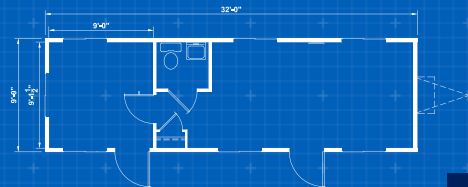

**Additional floor plans available. Floor plans and specifications may vary from those shown, and are subject to in-stock availability.*

MODELS M04410 & M04412



Size(s)

- 44' Long (including hitch)
- 40' Box size
- 10' or 12' Wide
- 8' Ceiling height

Windows / Doors

Horizontal slider windows
Two vision panel doors with standard locks

Electric

Fluorescent ceiling lights
Breaker panel

Interior Finish

Paneled walls
Vinyl tile floors
Gypsum ceiling
Private office(s)

Heating / Cooling

Electric baseboard heat
Thru-wall AC unit

Exterior Finish / Frame

Aluminum siding
I-Beam frame
Standard drip rail gutters

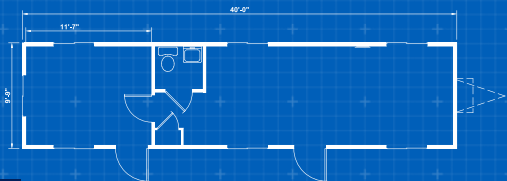

MODELS M05010 & M05012

Size(s)

50' Long (including hitch)
46' Box size
10' or 12' Wide
8' Ceiling height

Interior Finish

Paneled walls
Vinyl tile floors
Gypsum ceiling
Private offices(s)

Windows / Doors

Horizontal slider windows
Two vision panel doors with
standard locks

Heating / Cooling

Central HVAC or thru-wall AC

Electric

Fluorescent ceiling lights
Breaker panel

Exterior Finish / Frame

Aluminum siding
I-Beam frame
Standard drip rail gutters

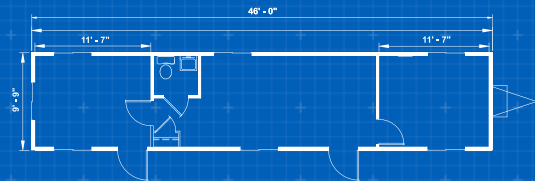

**Additional floor plans available. Floor plans and specifications may vary from those shown, and are subject to in-stock availability.*

MODELS M06012 & M06412

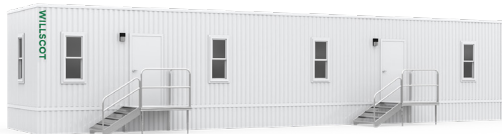

Size(s)

- 60' or 64' Long (including hitch)
- 56' or 60' Box size
- 12' Wide
- 8' Ceiling height

Windows / Doors

Horizontal slider windows
Two vision panel doors with standard locks

Electric

Fluorescent ceiling lights
Breaker panel

Interior Finish

Paneled walls
Vinyl tile floors
Gypsum ceiling
Private office(s)

Heating / Cooling

Central HVAC or thru-wall AC

Exterior Finish / Frame

Aluminum siding
I-Beam frame
Standard drip rail gutters

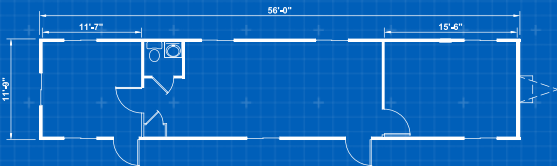

MODELS SM6024 & SM6424

Size(s)

60' or 64' Long (including hitch)
56' or 60' Box size
12' or 24' Wide
8' Ceiling height
Other double-wide sizes available

Interior Finish

Paneled walls
Vinyl tile floors
Gypsum ceiling
Private offices

Windows / Doors

Horizontal slider windows
Two vision panel doors with
standard locks

Heating / Cooling

Central HVAC or thru-wall AC

Electric

Fluorescent ceiling lights
Breaker panel

Exterior Finish / Frame

Aluminum siding
I-Beam frame
Standard drip rail gutters

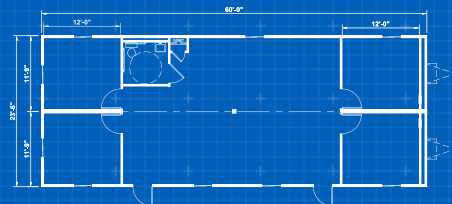

**Additional floor plans available. Floor plans and specifications may vary from those shown, and are subject to in-stock availability.*



FLEX™

Size(s)

20' Long

8' Wide

9' 6" Ceiling height

Additional floor plans can be created by coupling and stacking individual units together

Panels / Wall Covering

Metal clad insulated panels

Polyurethane insulation (R-14)

Windows

PVC frame

Tilt & turn opening

Double glazing with shutter

Doors

Insulated metal with

aluminum frame, transom

Phone / Data

Cat 6 2 each per module)

Electric

60 A.; 120/240v.; 1ph per unit

Floor

Tapiflex reinforced vinyl covering

High specimen mineral wool insulation (R-20)

Heating / Cooling

Combination through wall heat/cool unit with timer and remote control

**Additional floor plans available. Floor plans and specifications may vary from those shown, and are subject to in-stock availability.*

REDI-PLEX

Clear span portable office space for more permanent needs

When your business requires a larger, more permanent space solution our Redi-Plex buildings are the perfect solution. Durable, secure and easily configured to meet your needs, our Redi-Plex buildings offer advanced versatility. Large, open floorplans are created using clear span construction, eliminating interference from support columns. Whether you need an open floorplan or a custom layout with private offices, conferences rooms or break areas, our Redi-Plex buildings provide the flexibility to create the exact space you need. All

of our Redi-Plex buildings are made with durable, high quality materials that meet national and state building, electrical, mechanical and plumbing codes and are supported by the best customer service in the industry. We also provide a variety of additional products, including steps, ramps, and awnings, and convenient furniture packages thoughtfully designed to fit your space, saving you time and money, so that your space is outfitted with everything you need to be ready to work.

**Additional floor plans available. Floor plans and specifications may vary from those shown, and are subject to in-stock availability.*



MODELS C0208 & C0408



Size(s)

20' or 40' Long (including hitch)
8' Wide
8' Ceiling height

General

Skid mounted office unit is constructed using one-trip ISO shipping container unit.

Roof Structure

Exterior panels are white with green trim / border color.

Windows / Doors

High single glazed windows
Hollow metal doors

Insulation R-Values

Roof: R-13
Walls: R-13

Floor

Tile with vinyl wall base

Heating / Cooling

Environmentally controlled with heat and AC

Electrical

MC Cable
Distrobution panels, 102/208/230V, 1ph
Duplex receptacles
Toggle type switches control interior lighting

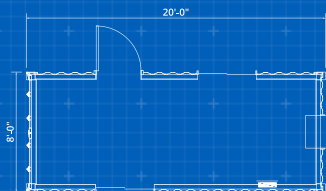

**Additional floor plans available. Floor plans and specifications may vary from those shown, and are subject to in-stock availability.*

MODEL CS408

Size(s)

20' or 40' Long (including hitch)
8' Wide
8' Ceiling height
15' Office space / 25' Storage

General

Skid mounted office unit is constructed using one-trip ISO shipping container unit.

Floor

Tile with vinyl wall base

Windows / Doors

High single glazed windows
Hollow metal doors

Insulation R-Values

Roof: R-13
Walls: R-13

Roof Structure

Prefinished interior ceiling panel with matching battens

Heating / Cooling

Environmentally controlled with heat and AC

Electrical

MC Cable
Distribution panels,
102/208/230V. 1ph
Duplex receptacles
Toggle type switches control interior lighting.

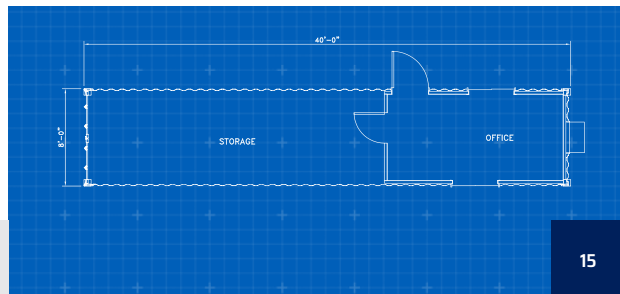

**Additional floor plans available. Floor plans and specifications may vary from those shown, and are subject to in-stock availability.*

MODELS S04812 & S06412

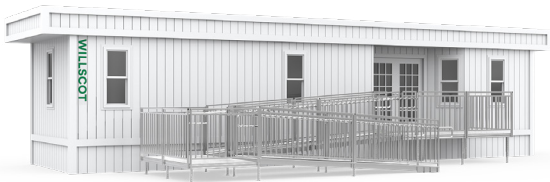

Size(s)

48' or 64' Long (including hitch)
44' or 60' Box size
12' Wide
8' Ceiling height

Features

Large display / reception area
Private office(s)
Carpeting throughout
ADA Restroom
Coffee bar

Windows / Doors

Large glass windows
Recessed french door
Vision panel doors with
standard locks

Interior Finish

Vinyl covered gypsum walls
Commercial carpeting
Gypsum ceiling

Heating / Cooling

Central HVAC and duct heating

Electric

Fluorescent ceiling lights
Breaker panel

Exterior Finish / Frame

I-Beam frame
T1-11 siding
Standard drip rail gutters

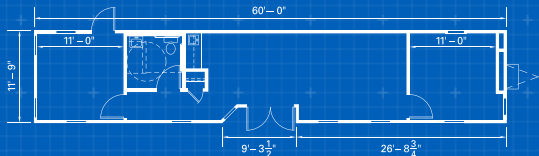

MODELS S04824 & S06424

Size(s)

- 48' or 64' Long (including hitch)
- 44' or 60' Box size
- 24' Wide
- 8' Ceiling height

Features

- Large display / reception area
- Private office(s)
- Carpeting throughout
- ADA Restroom
- Coffee bar

Windows / Doors

Large glass windows
Recessed french door
Vision panel doors with standard locks

Interior Finish

Vinyl covered gypsum walls
Commercial carpeting
Gypsum ceiling

Heating / Cooling

Central HVAC and duct heating

Electric

Fluorescent ceiling lights
Breaker panel

Exterior Finish / Frame

I-Beam frame
T1-11 siding
Standard drip rail gutters

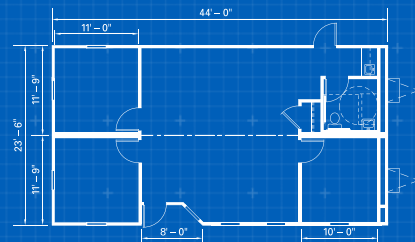

**Additional floor plans available. Floor plans and specifications may vary from those shown, and are subject to in-stock availability.*

MODEL CT208



Size(s)

20' Length

8' Wide

Additional lengths available in some areas

Features / Services

High security metal

High security locking systems

Ground level entry

Short or long-term on-site storage

Immediate availability

Locking Systems

Tamper-proof lock boxes: Cover prevents bolt cutters from cutting through lock

The Enforcer: Lock cannot be opened without a special key. Fits all containers and semi-type storage trailers.

Master lock box: Locking system with locks that cannot be removed with bolt cutters

Shelving

Easy to install: No tools required
Uses existing D-rings: No container modifications

Heavy duty: Securely holds your materials

Adjustable: Holds a variety of material sizes and lengths

Removable: Easily relocated and reconfigured

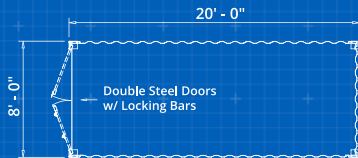

**Additional floor plans available. Floor plans and specifications may vary from those shown, and are subject to in-stock availability.*

MODEL CT408

Size(s)

40' Length

8' Wide

Additional lengths available in some areas

Features / Services

High security metal

High security locking systems

Ground level entry

Short or long-term on-site storage

Immediate availability

Locking Systems

Tamper-proof lock boxes: Cover prevents bolt cutters from cutting through lock

The Enforcer: Lock cannot be opened without a special key. Fits all containers and semi-type storage trailers.

Master lock box: Locking system with locks that cannot be removed with bolt cutters

Shelving

Easy to install: No tools required
Uses existing D-rings: No container modifications

Heavy duty: Securely holds your materials

Adjustable: Holds a variety of material sizes and lengths

Removable: Easily relocated and reconfigured

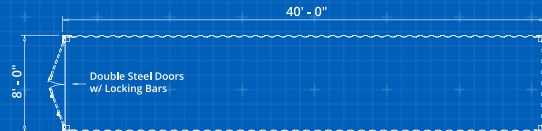

**Additional floor plans available. Floor plans and specifications may vary from those shown, and are subject to in-stock availability.*

READY TO WORK

The fully streamlined space solution.

When it's time to be productive on a project, you need temporary space that's as ready as you are. Our modular solutions are complete to the last detail, so you can forget about building logistics and focus on the job at hand. One call to WillScot and you're ready to work.

When the solution is perfect, productivity is all you see.

SIZED FOR YOU

A perfect fit, from compact to spacious to stackable

CONVENIENT FACILITIES

Optional restroom available in almost any unit

BRIGHTEN YOUR DAY

Windows and doors that keep your workspace open and well-lit

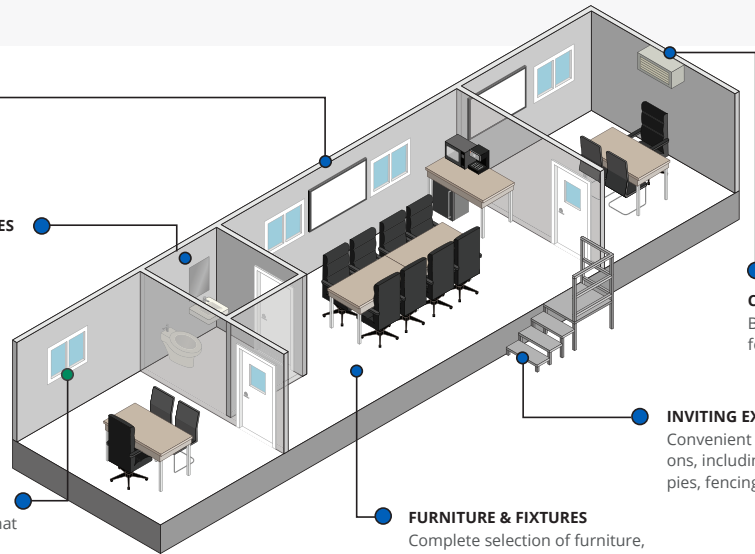

CLIMATE CONTROL

Built-in central HVAC for year-round comfort

INVITING EXTERIORS

Convenient and accessible additions, including ramps, steps, canopies, fencing, security and more

FURNITURE & FIXTURES

Complete selection of furniture, workplace appliances and lighting and flooring options

ONE STOP SHOP

From building configuration to delivery to setup, we cover every detail to make your job easier.

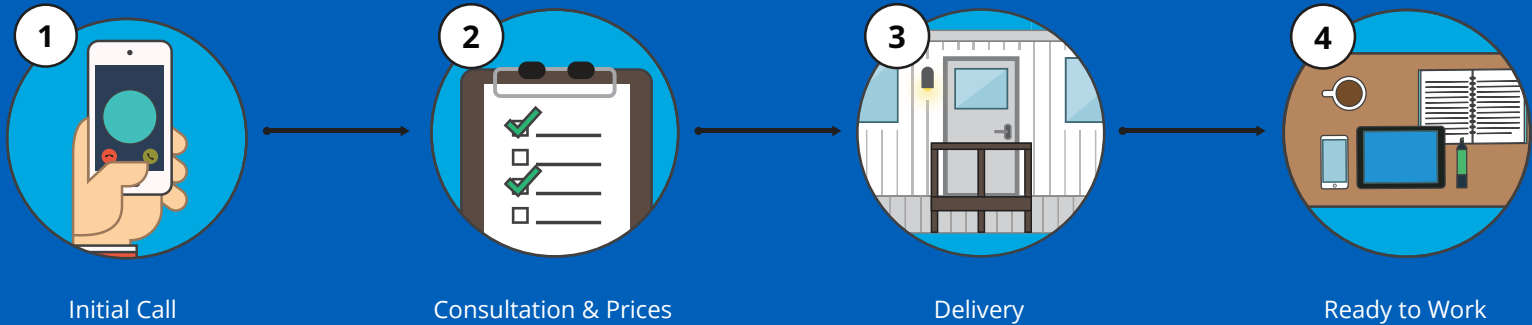

THE ESSENTIALS

Office Area

From basic desks to semiprivate work areas, we can provide the necessary furniture and storage that make your workspace a productive one.



Common Space Area

Our furniture and solutions facilitate collaborative working and training while addressing common space needs.

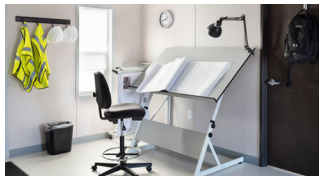

Break Room Area

From a short break to full lunchtime needs, our refrigeration, cooking and coffee mess items outfit a space that will keep your employees fueled up and at the top of their game.



Outside Area

We've developed packages specifically addressing the exterior needs of your workspace as well. All are designed to Increase the safety, accessibility or security of your temporary office.



**Additional floor plans available. Floor plans and specifications may vary from those shown, and are subject to in-stock availability.*



TM

800.782.1500 | WILLSCOT.COM

WILLSCOT, INC. CORPORATE HEADQUARTERS
901 S Bond Street Suite 600 • Baltimore, MD • 21231

